

SHIN SHIN MARINE

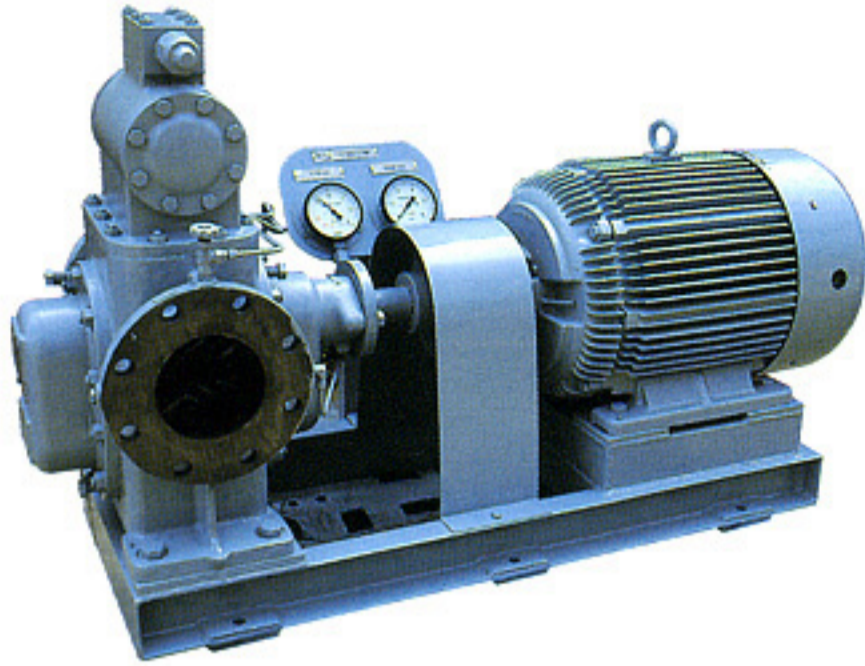

 SHIN SHIN MACHINERY CO., LTD.



- Applications
 - H.F.O Trans. Pump
 - Others

■ Principal Particulars

Item	Model	40	50	65	80	90	100	110	120	135	150	175	200	
Rotation		Clockwise viewed from driver end												
Suction & Discharge bore(mm)	S	φ 150				φ 200				φ 250				
	D	φ 125				φ 150				φ 200				
Standard Capacity(m ³ /hr)	60Hz	6P	40	50	-	-	-	-	-	-	-	-	-	-
		8P	-	-	65	80	90	100	110	120	135	150	175	200
	50Hz	6P	33	40	-	-	-	-	-	-	-	-	-	-
		8P	-	-	55	65	75	85	90	100	110	125	145	165
Pressure(kg/cm)		Up To 7 kg/cm ²												
Stuffing box seal		Gland Packing or Mechanical Seal												
Weight(kg)		Refer to the Outline Drawing												

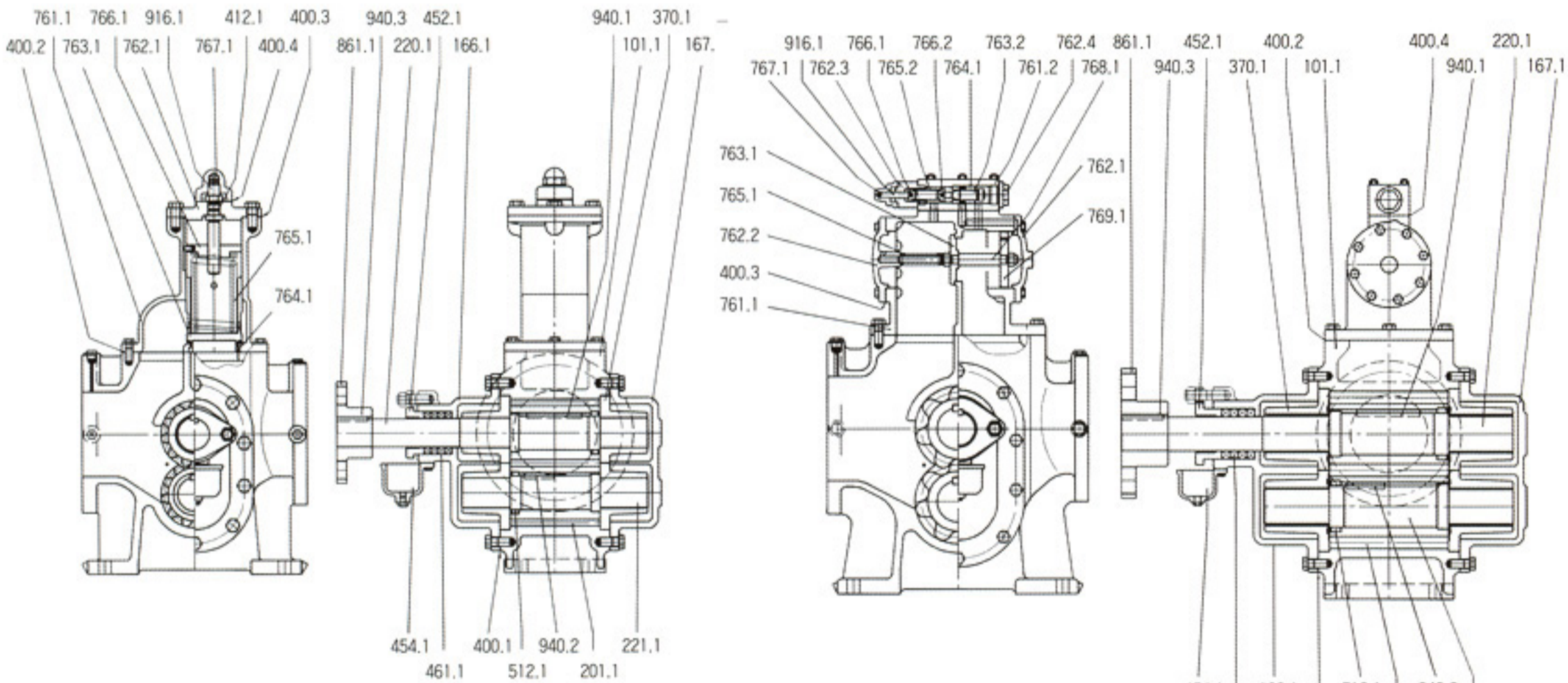

(HG 40 ~ 50)

(HG 65 ~ 200)

■ Standard Materials (HG 40~50)

Part No.	Name Of Part	REQ. NO. FOR 1PUMP	MATERIAL	
			Name	KS
101.1	PUMP CASING	1	CAST IRON	GC200
166.2	SIDE COVER(INNER)	1	CAST IRON	GC200
167.1	SIDE COVER(OUTER)	1	CAST IRON	GC200
201.1	GEAR	2	CARBON STEEL	SM45C
220.1	DRIVE SHAFT	1	CARBON STEEL	SM45C
221.1	DRIVEN SHAFT	1	CARBON STEEL	SM45C
370.1	SLIDING BEARING	4	CAST IRON + WHITE METAL	GC200 + WM1
400.1	GASKET	2	OIL PAPER	
400.2	GASKET	1	OIL PAPER	
400.3	GASKET	2	OIL PAPER	
400.4	GASKET	1	OIL PAPER	
400.5	GASKET	1	NON AXBESTOS	
433.1	MECHANICAL SEAL	1		
471.1	SEAL COVER	1	STAINLESS STEEL	STS304
512.1	GEAR SET RING	2	CARBON STEEL	SM45C
761.1	VALVE BODY	1	CAST IRON	GC200
761.2	VALVE BODY	1	CAST IRON	GC200
762.1	VALVE COVER	1	CAST IRON	GC200

Part No.	Name Of Part	REQ. NO. FOR 1PUMP	MATERIAL	
			Name	KS
762.2	VALVE COVER	1	CAST IRON	GC200
762.3	VALVE COVER	1	CAST IRON	GC200
762.4	VALVE COVER	1	CAST IRON	GC200
763.1	SAFETY VALVE	2	CARBON STEEL	SM45C
763.2	SAFETY VALVE	1	STAINLESS STEEL	STS410J1
764.1	VALVE SEAT	1	BRONZE	BC6
765.1	VALVE SPRING	4	SPRING STEEL	SPS6
765.2	VALVE SPRING	2	SPRING STEEL	SPS6
766.1	SPRING CARRIER	1	STEEL	SS41
766.2	SPRING CARRIER	2	STEEL	SS41
767.1	VALVE CAP	1	CAST IRON	GC200
768.1	PISTON ROD	1	CARBON STEEL	SM45C
769.1	PISTON VALVE	1	CARBON STEEL	SM45C
861.1	COUPLING HALF	1	CAST IRON	SC200
916.1	ADJUSTING SCREW	2	STEEL	SS41
940.1	DRIVE SHAFT KEY	1	CARBON STEEL	SM45C
940.2	DRIVEN SHAFT KEY	1	CARBON STEEL	SM45C
940.3	COUPLING KEY	1	CARBON STEEL	SM45C

■ Standard Materials (HG 65~200)

Part No.	Name Of Part	REQ. NO. FOR 1PUMP	MATERIAL	
			Name	KS
101.1	PUMP CASING	1	CAST IRON	GC200
166.1	SIDE COVER(INNER)	1	CAST IRON	GC200
167.1	SIDE COVER(OUTER)	1	CAST IRON	GC200
201.1	GEAR	2	CARBON STEEL	SM45C
220.1	DRIVE SHAFT	1	CARBON STEEL	SM45C
221.1	DRIVEN SHAFT	1	CARBON STEEL	SM45C
370.1	SLIDING BEARING	4	LEADED TIN BRONZE	LBC4
400.1	GASKET	2	OIL PAPER	
400.2	GASKET	1	OIL PAPER	
400.3	GASKET	1	OIL PAPER	
400.4	GASKET	1	OIL PAPER	
412.1	O-RING	1	EPDM	
452.1	PACKING GLAND	1	CAST IRON	GC200
454.1	OIL PAN	1	CAST IRON	GC200
461.1	PACKING	4	NON METALLIC	
512.1	GEAR SET RING	2	CARBON STEEL	SM45C
761.1	VALVE BODY	1	CAST IRON	GC200
762.1	VALVE COVER	1	CAST IRON	GC200

Part No.	Name Of Part	REQ. NO. FOR 1PUMP	MATERIAL	
			Name	KS
763.1	SAFETY VALVE	1	CARBON STEEL	SM45C
764.1	VALVE SEAT	1	STAINLESS STEEL	STS410J1
765.1	VALVE SPRING	1	SPRING STEEL	SPS6
766.1	SPRING CARRIER	1	STEEL	SS41
767.1	VALVE CAP	1	CAST IRON	GC200
861.1	COUPLING HALF		CAST IRON	GC200
916.1	ADJUSTING SCREW	1	STEEL	SS41
940.1	DRIVE SHAFT KEY	1	CARBON STEEL	SM45C
940.2	DRIVEN SHAFT KEY	1	CARBON STEEL	SM45C
940.3	COUPLING KEY	2	CARBON STEEL	SM45C

50HZ

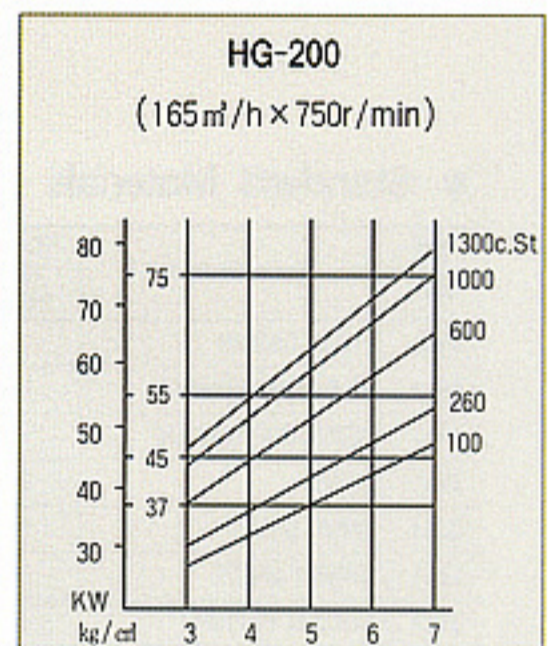
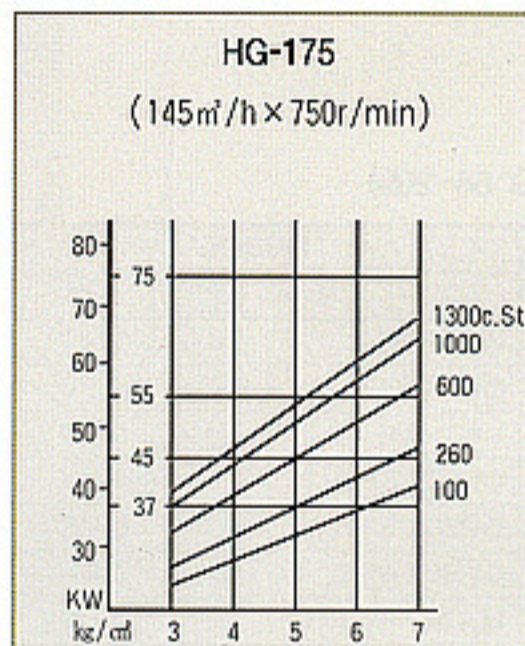
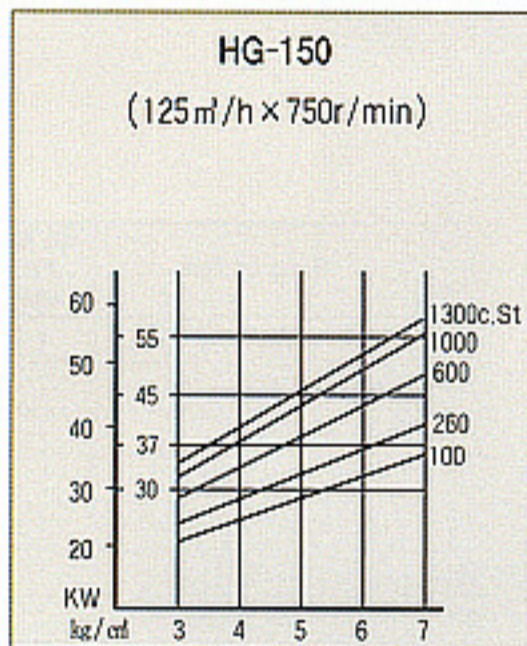
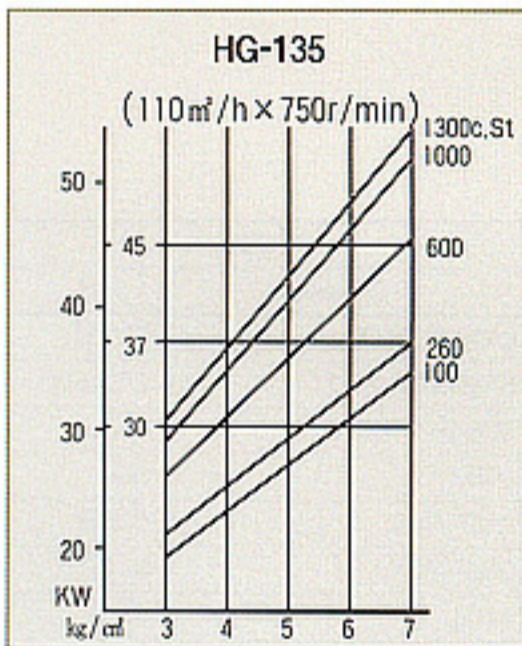
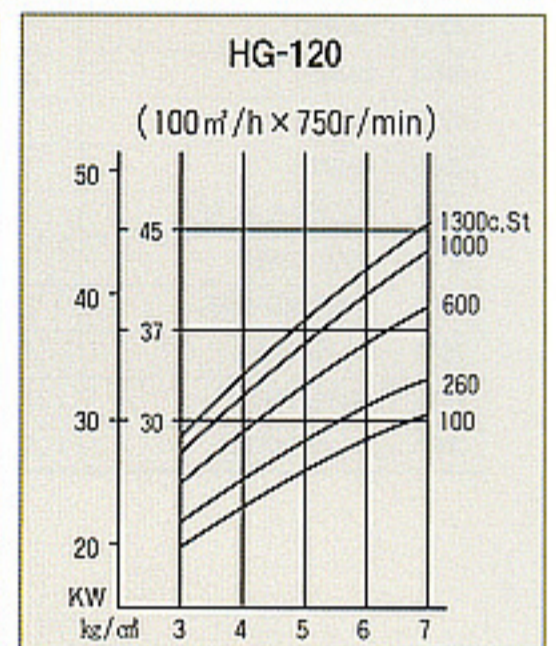
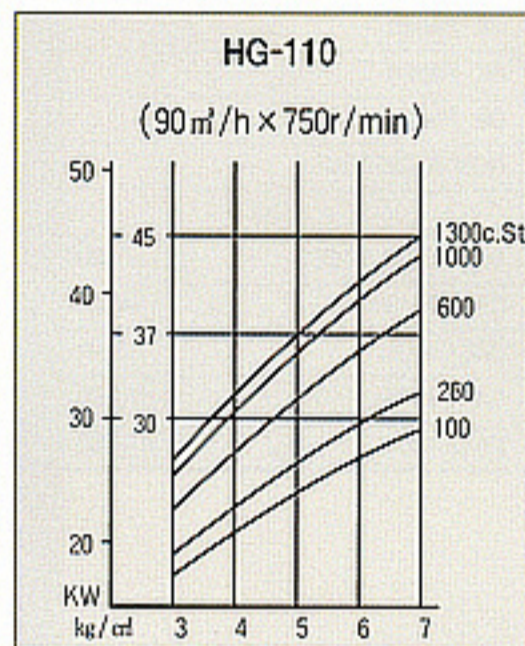
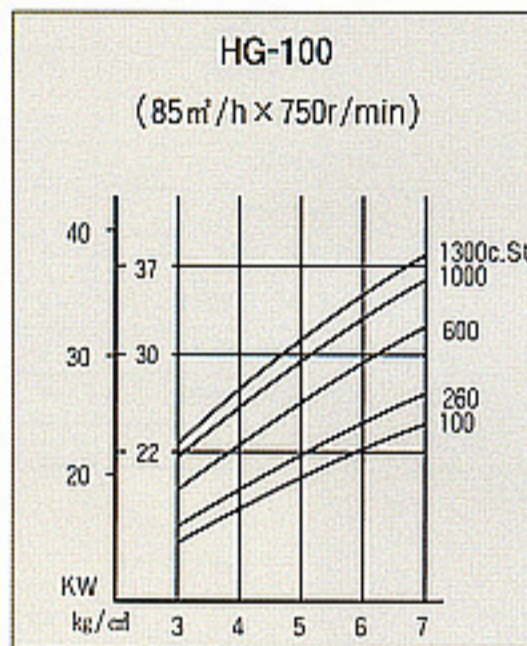
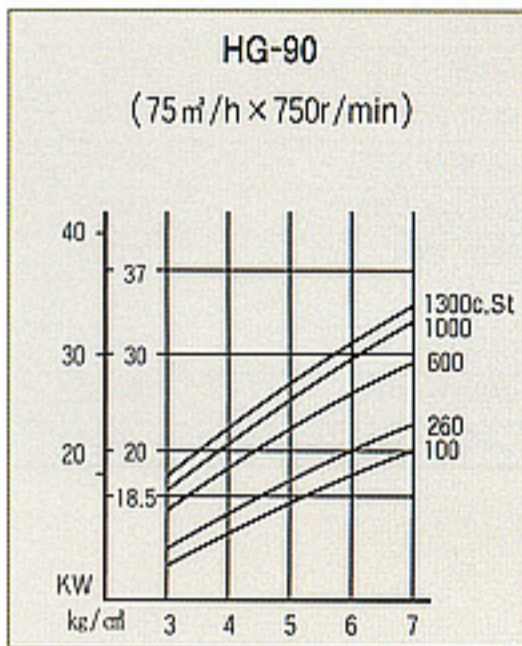
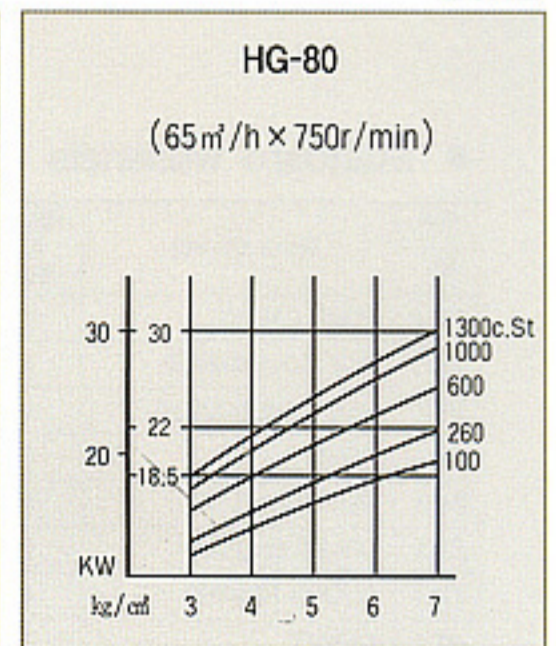
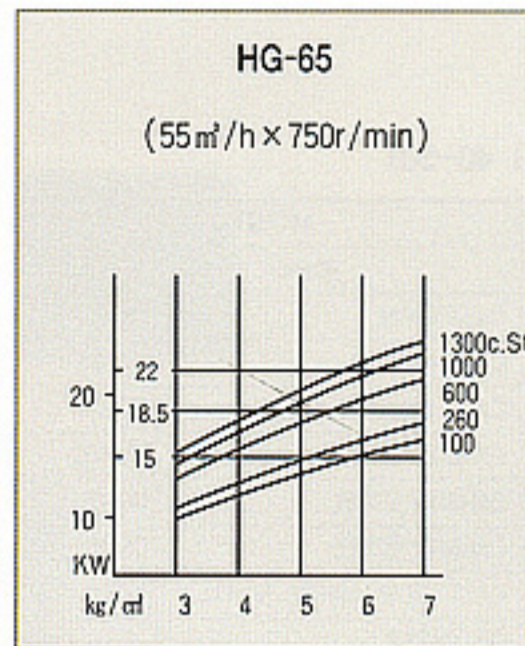
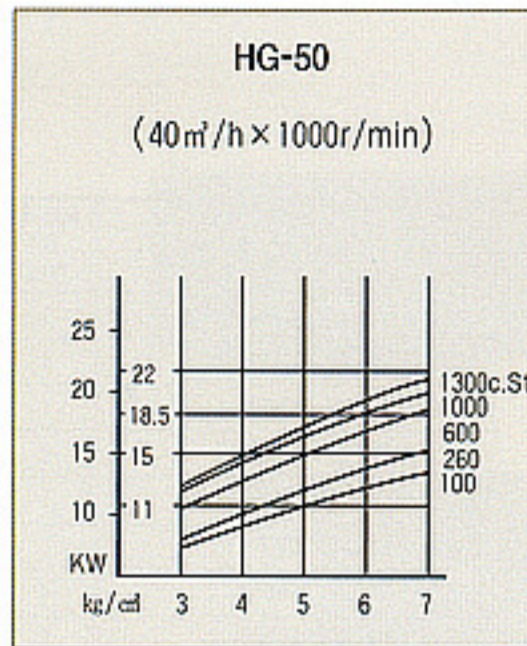
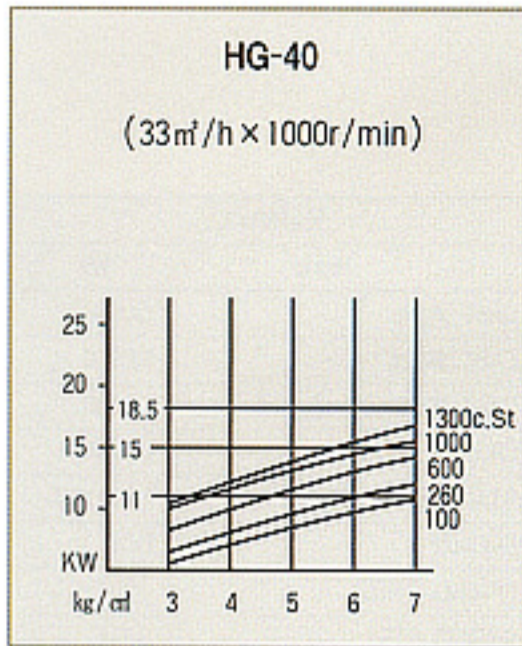

60HZ

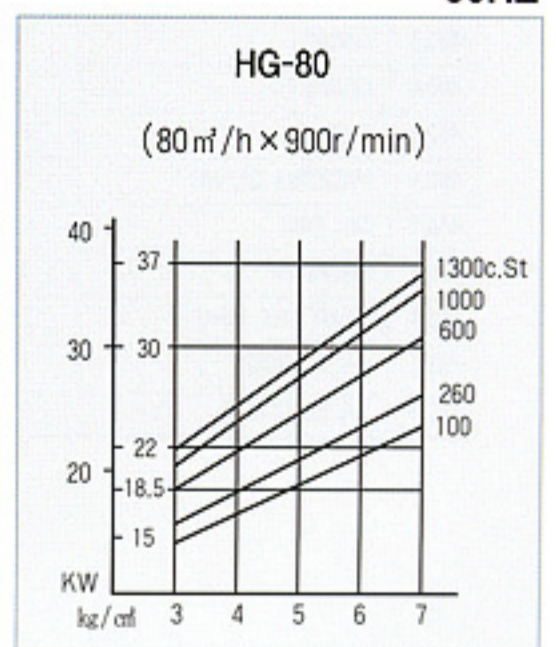
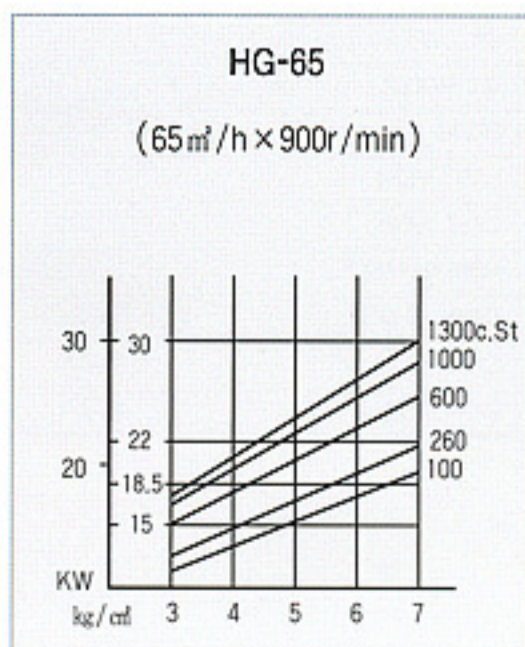
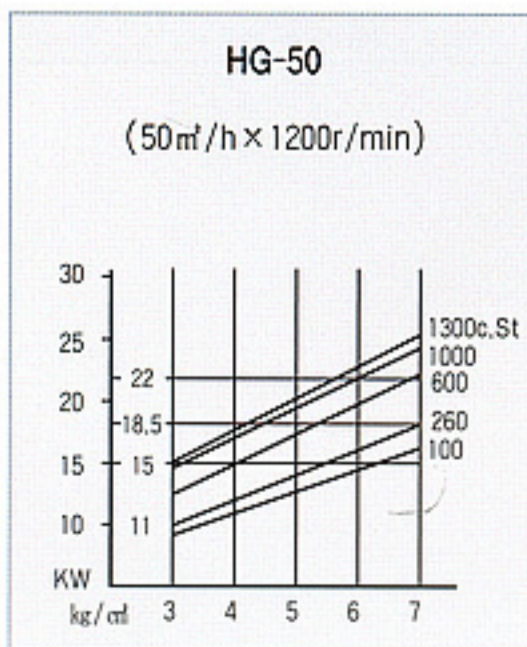
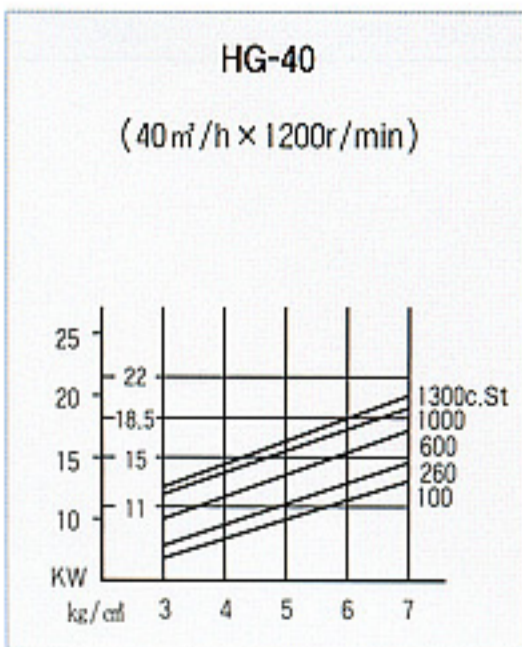

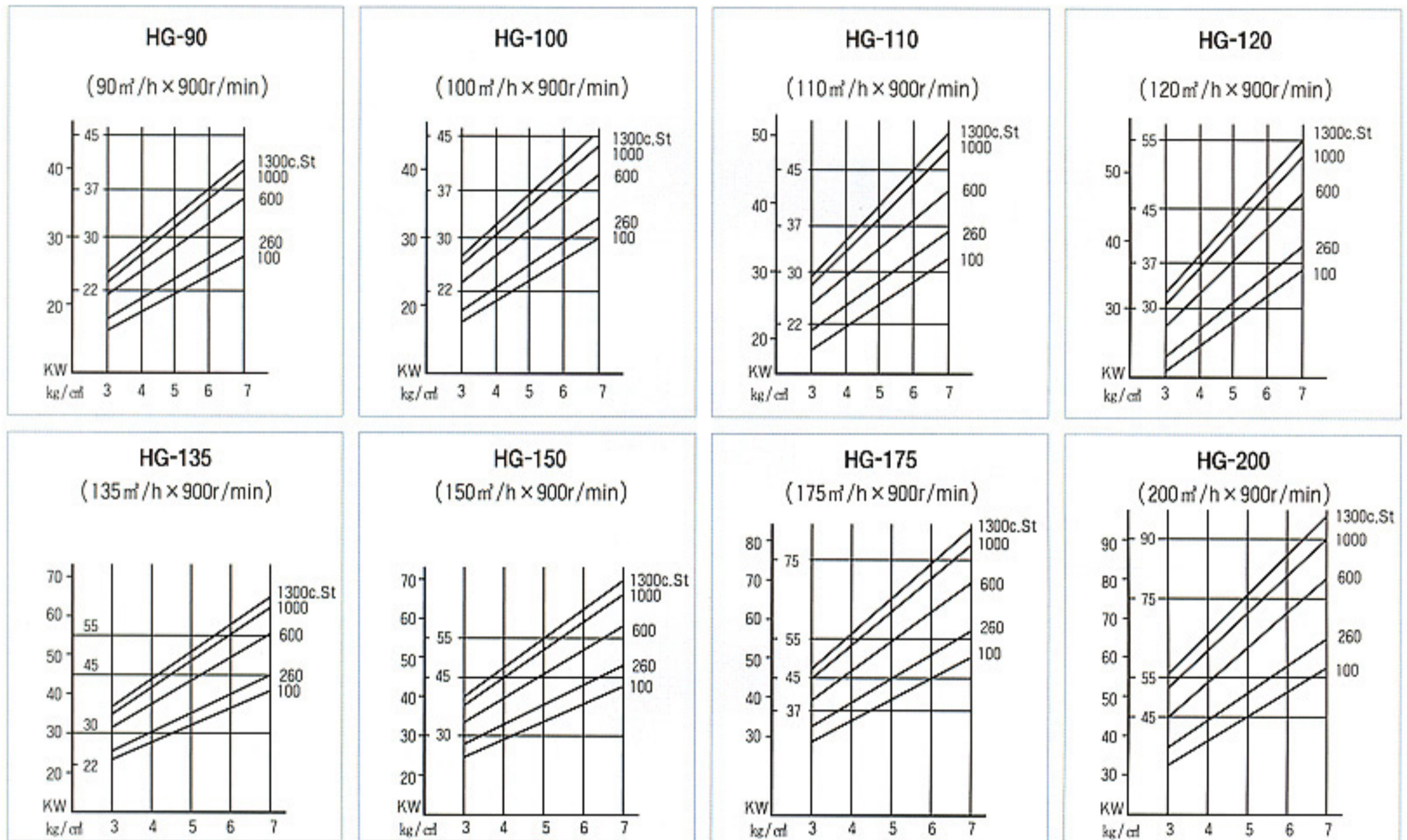

■ Lubrication of Bearing

The metal bearing is internally set in casing which is lubricated by the pumping liquid.

■ Relief Valve

1. Relief valve is set together with casing body.
2. Capacity of relief valve.

Discharge pressure maximum arising value is designed to be less than 132% of designed total pressure, even if the discharge valve is full shutted.(But when designed total pressure is less than 5 kgf/cm² , the pressure-arising value should be less than 1.6 kgf/cm².)

Pressure set for the relief valve

HG type Designed total pressure + 0.2 kgf/cm².
(Highest-7.2kgf/cm² Lowest-2.2kgf/cm²)

■ Standard Accessories

- Flexible coupling.....1
- Safety cover.....1
- Suction gauge.....1
- Discharge gauge.....1
- Common base.....1

■ Standard Spare Parts

- Bearing MetalEach1
- Gland Packing/Mech. Seal1
- Bolt, Nut & Washer for flexible coupling.....1set

HG GEAR PUMP

Horizontal in-line gear pump

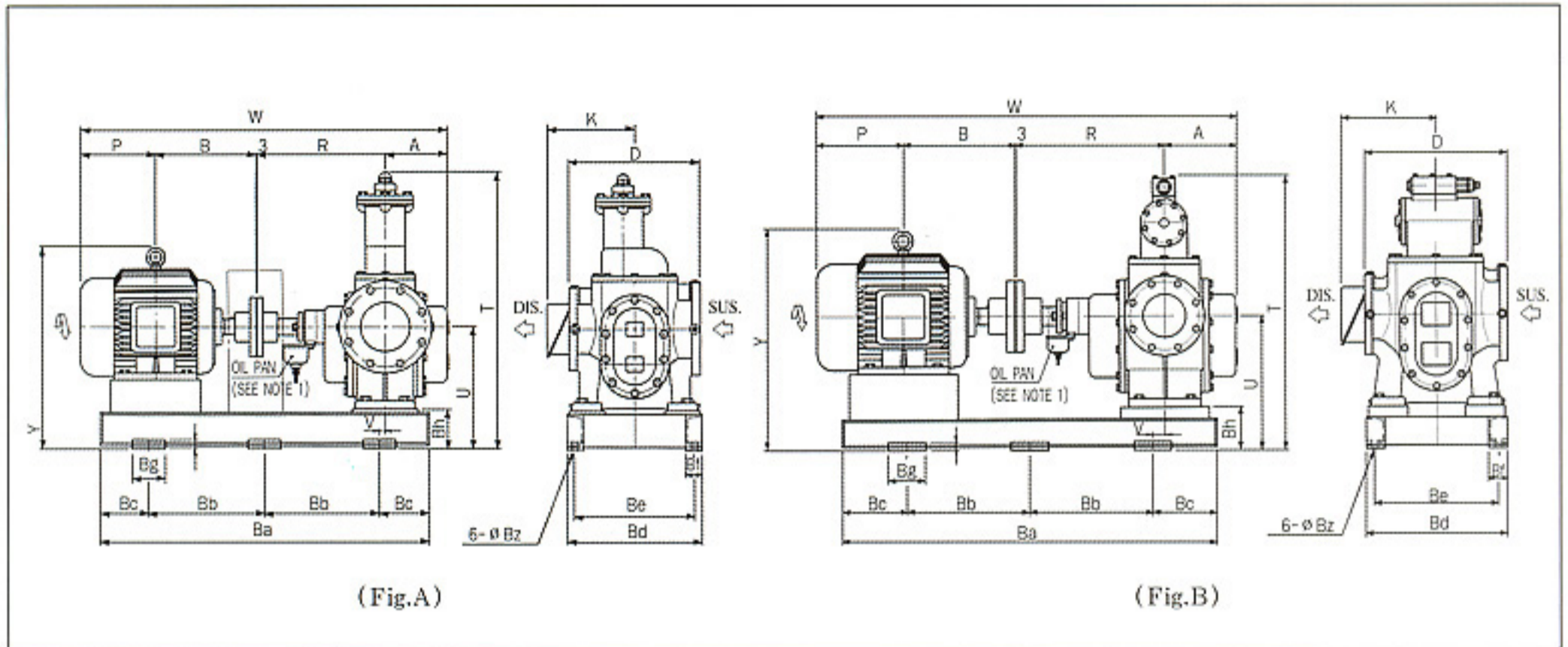

WITH 1800rpm MOTOR

Type	FIG	Motor		Bore		Size(mm)											Base(mm)							Weight(kg)					
		Kw	rpm	Suc	Del	A	B	D	K	P	R	T	U	V	W	Y	Ba	Bb	Bc	Bd	Be	Bf	Bg	Bh	Bi	Bz	Body	Base	Motor
HG40	A	15	1200	150	125	190	317	400	297	314	390	845	370	30	1268	616	1050	400	125	390	345	50	100	120	28	19	160	48	177
		19					377		331	331				50	1291	665	1100		150	410	365							51	250
HG50	A	15	1200	150	125	185	371	400	297	314	390	845	370	30	1263	616	1050	400	125	390	345	50	100	120	28	19	155	48	177
		19					377		331	331				50	1286	665	1100		150	410	365							51	250
HG65	B	19	900	150	125	220	396	460	331	351	445	850	400	10	1415	695	1150	450	125	450	405	50	100	120	28	19	230	53	277
		22					432		449	385				30	1485	722	1200		150	505	460							56	380
HG80	B	22	900	150	125	235	432	460	449	385	445	850	400	30	1500	722	1200	450	150	505	460	50	100	120	28	19	230	56	380
		30					445							397	1525				1525	56	420								
HG90	B	22	900	150	125	235	432	460	449	385	445	850	400	30	1500	722	1200	450	150	505	460	50	100	120	28	19	230	56	380
		30					445							397	1525				1525	56	420								
HG100	B	30	900	200	150	265	445	500	449	397	515	950	470	20	1625	792	1300	500	150	470	410	65	130	150	30	23	320	62	420
		37					434		477	422				25	1639	823			495	435	522								
HG110	B	30	900	200	150	265	445	500	449	397	515	950	470	20	1625	792	1300	500	150	495	435	65	130	150	30	23	320	62	420
		37					434		477	422				25	1639	823			495	435	522								
HG120	B	37	900	200	150	265	434	500	477	422	515	950	470	25	1639	823	1300	500	150	495	435	65	130	150	30	23	320	62	420
		45					452		442	1677				1677	575														
HG135	B	37	900	250	200	285	434	500	477	422	550	960	470	0	1694	823	1350	550	125	495	435	65	130	150	30	23	380	64	522
		45					452		442	1732				1732	575														
HG150	B	45	900	250	200	285	452	500	477	422	550	960	470	0	1732	823	1350	550	125	495	435	65	130	150	30	23	380	64	522
		55					514		517	500				70	1852				855	1500	200							555	495
HG175	B	45	900	250	200	325	452	600	477	422	650	995	505	45	1872	858	1500	550	200	560	500	65	130	150	30	23	475	72	575
		55					514		517	500				45	1992				920	1600	490							75	150
HG200	B	55	900	250	200	325	514	600	517	525	650	500	535	45	1992	920	1600	600	200	560	490	75	156	180	30	23	475	80	750
		75					540		1025	2043				2043	890														



Homepage : <http://www.sspump.com>

E-mail : sales@sspump.com

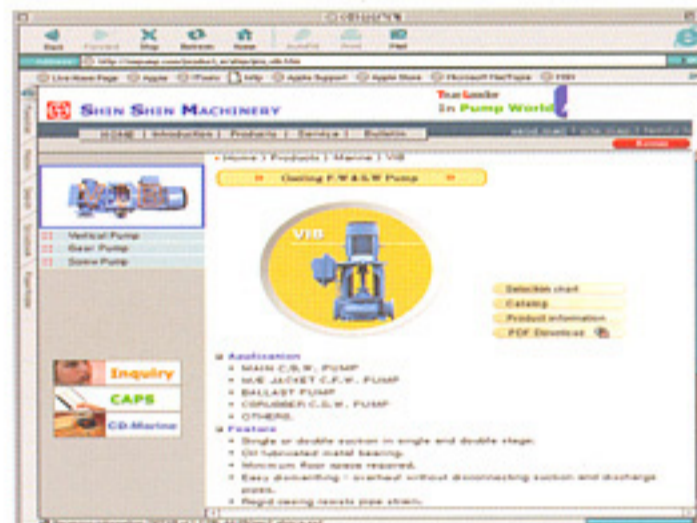

SHIN SHIN MACHINERY CO., LTD.

Head Office & Factory

940-13 Yerim-ri, Chongwan-Myen, Gijang-Gun, Pusan, Korea.

Phone : (051) 727-5300~4

Telefax: (051) 727-5305~8

Seoul Office

Phone : +82-2-752-8419/8403, 778-8832

Telefax: -82-2-755-3156